

# *2000 Prevost Liberty Lady Classic*

VANDERMERE EDITION



Liberty Coach is known for excellence in motorcoach construction, leading the way in style, design, and mechanical technology with meticulous craftsmanship incorporating only the finest quality materials to create a coach that delivers you to the next level of excellence. Those with discriminating taste will appreciate the Liberty difference. Liberty pays close attention to system placements and weight distribution of components to assure you the best ride and handling of the Prevost chassis and to make the most efficient use of space. Stunning interiors set Liberty apart with exquisite interior fabrics and custom made furniture and cabinetry that make for an incomparably finished motorcoach, unequaled and unavailable anywhere else in the industry.

## **Liberty Coach #436 for sale by owner**

**Please call for current price**

Jim Elmore 918 688 6417

Linda French 918 688 6545

<http://www.2000liberty.info>

This coach has the highly desirable Liberty Vandermere layout, which creates a curved flow of space eliminating the "shotgun" effect that is prevalent in other layouts. Inside she has a light and spacious feel, and her accommodations are made of every luxury you could possibly need.

Driven on a regular basis and all systems in tip-top order. Higher horse power engine. Exceptional comfort and efficiency of over the road air. Gorgeous marble flooring through to bedroom. Stunning two color marble shower with the ultimate in bathing comfort: water temperature control valve and built in seat. Private water closet with vanity. Hunter Douglas honeycomb/blackout shades throughout.

No pets, no smoking.

Professionally maintained.

Ready to hit the road.

Ready for immediate sale.

**2000 PREVOST LIBERTY LADY CLASSIC  
VANDERMERE EDITION**

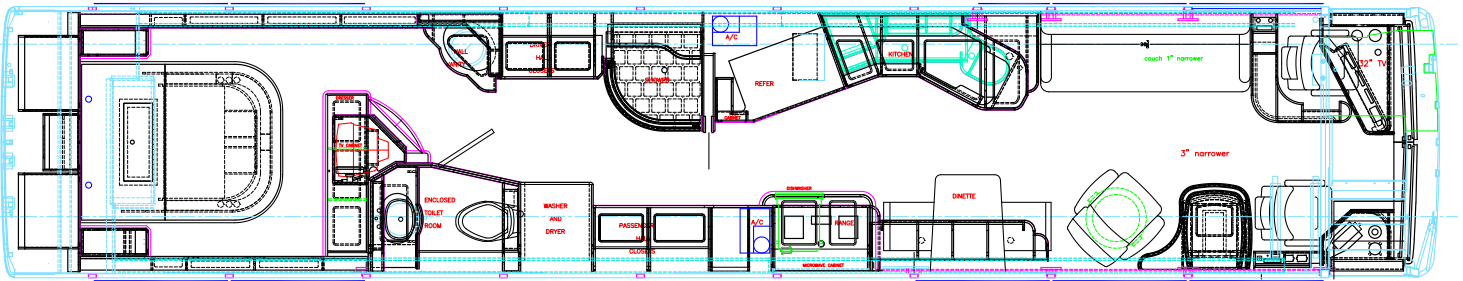

This drawing is a 2001 edition of this coach. The layout is identical.

**Outside views**



Forward starboard view



Forward port view



Aft starboard view



Aft port view with awnings extended and bay doors open



Forward starboard view with awnings extended



Forward port view with awnings extended and bay doors open

**Specifications and features**

- Liberty Coach #436
- Complete set of owner's manuals and extensive service history documentation
- New Michelin tires and Lifeline AGM house batteries in 2007; new generator and chassis batteries in 2008
- New KVH in-motion satellite system in 2007
- High-definition TVs throughout
- Non-smoking and no pets

**EXTERIOR/UNDERCOMPARTMENT**

- ACR Spotlight
- 4 roof mounted Air Horns- 2 long & 2 short
- Chrome Ramco dual control, heated exterior mirrors
- Exclusive time-proven Liberty Coach designed auto level system with independent front, left rear and right rear manual override
- Liberty Coach manufactured docking light trim
- Exclusive Liberty Coach mirror polished exterior with raised area on sides polished
- Polished stainless steel bumpers
- Polished stainless steel tail light covers
- Liberty Coach manufactured polished stainless steel side rails
- 10 exterior yard lights with controls at dash, passenger cabinet, and bedroom
- Exterior light mounted above power inlet on both sides for night hook-up
- Exterior light at front door
- Front bra designed to match exterior paint scheme
- 2 exterior lights mounted on the bottom of entertainment center bay door
- Zip Dee window awnings

## Port bays



Storage bay, electrical and generator radiator bay, generator and water bay



Slide-out tray, fully carpeted drawers



Pass through storage bay with slide-out trays, concealed drawer cabinet



Shore power breaker and source selector switch, inverters



12V fuse panel, inverters, generator starting battery, generator radiator



12V fuse and control area



Generator bay, water bay



External water bay monitors and controls

- Zip Dee air & electric patio awning with remote
- 4 Zip Dee chairs embroidered with Liberty Coach logo
- Wheel decor package
- Drive axle flap with polished stainless steel panel on rear fenders
- Holding tank dump hose storage in polished stainless steel box located above engine batteries
- Rear mud flap with polished stainless steel trim
- Docking lights cut into rear bumper
- Custom designed polished stainless steel exhaust tips for main engine, generator, and Webasto exhaust
- Racor engine filter
- Trailer hitch with light converter package for 3 or 4 tail light combinations
- Exclusive Liberty Coach rear camera lens clearing device operated from dash
- Durable, high-quality carpet for undercompartment flooring
- All stainless steel screws and bolts in undercompartment construction
- Hanging drawers in first bay on both sides
- Decorator laminate on lower bay cabinets
- Metal floor in water compartment
- Enclosed holding tank & water compartment
- Hot & cold water faucet in water tank compartment with hand sprayer
- Cold water hose connection in holding tank compartment for wash down and sewer hose clean-up

## A/C & HEATING SYSTEMS

- 4 14,000 BTU Cruise Air reverse cycle heat pump/air conditioning systems with SMX controls
- Air conditioning ducted through ceiling with concealed return air grills
- 80,000 BTU Webasto with soldered hard wall copper plumbing with 6 heat exchangers continuously circulating hot water heat through the main engine and domestic water heater
- Webasto heat zoned on three thermostats including one in water bay
- Electric heat in bathroom toeboard
- Thermostatically controlled electric heat in water bay

## Starboard bays



From the left, the fresh water bay, the entertainment bay and the storage bay



Engine compartment with sanitary hose and parts storage



Storage compartment for hoses, spare fluids, parts



Hot and cold water faucet, fresh water tank



Entertainment center, storage bay with concealed drawers



Grill extended, slide-out tray extended, fully carpeted drawers



Outside stereo, television, speakers, grill, refrigerator, carpeted drawers

## ELECTRICAL SYSTEMS

- Continuous and uninterrupted stranded wiring
- 12 volt house electrical system
- Backlighted 110 volt marine breaker panel with line voltage & amperage gauges
- 20 kW Kohler generator on roll-out with centrally controlled air bag suspension
- Exclusive Liberty Coach Quiet Generator sound insulation
- Liberty Coach's 70 amp automatic shore power transfer switch
- 2 2500 watt 12 volt Heart Interface Inverters
- 3 8D 450 minute reserve capacity gel batteries with custom designed battery installation to allow an average service life of 5 years
- Maintenance-free generator starting battery
- Exclusive Liberty Coach engineered Battery Watchdog automatic generator starting system
- Shore power inlets on both port and starboard sides
- 55' electric shore power cord reel
- Aesthetically pleasing switch locations
- Low and high voltage protection via circuit breakers and fuses conveniently located

## WATER SYSTEMS

- 160 gallon polished stainless steel fresh water tank
- 135 gallon aluminum holding tank
- Enclosed water compartment with decorator laminate
- Metal floor in water and holding compartment
- Hot & cold water faucet in water tank compartment with hand sprayer
- Cold water hose connection in holding tank compartment for wash down and sewer hose clean-up
- Entire fresh water system, 1/2" ID tubing for constant pressure and volume in all areas
- 20 gallon electric water heater
- Auto fresh water tank fill while connected to city water supply
- Fresh water & holding tank monitors at 110 volt in front overhead cabinet
- City water inlet on both sides
- Electric gray water by-pass

**Salon**



Mirrored and carpeted entry with solid surface stairs



Cockpit

- Electric holding tank dump valve on driver and passenger side
- Macerator pump out system for holding tank
- Emergency water shut-off valves located at each faucet
- Upgraded 110 volt Headhunter water pump with pressure vessel
- Dual water filter for all coach water
- Additional in-line filtration for refrigerator tap, icemaker and sink filtered water tap

**AUDIO/VISUAL SYSTEMS**



Sofa with storage below (will fold out to double bed)



Dining table from salon; a leaf extension can be used

- 24" ViewSonic HDTV in front overhead concealed behind black acrylic panel with separate audio amplifier
- Remote TV speakers centered over each couch
- Bose Lifestyle 30 Dolby Pro-Logic surround sound system with AM/FM and 6 disc CD changer
- Alpine AM/FM CD player in bedroom
- 22" ViewSonic HDTV in bedroom concealed behind black acrylic panel
- 40 channel high output Cobra 29 LTD Classic CB radio with remote external speaker
- Alpine AM/FM with navigation DVD system at dash
- Lower bay entertainment center: 22" ViewSonic HDTV, Alpine AM/FM-Cassette player, storage drawers and phone jack
- Concord electric TV antenna
- KVH R5 in-motion satellite dish, new 2007
- DishNetwork 211 HD receivers



Dining table from galley



Liberty's entertainment center overhead, desk to starboard

**DASHBOARD/ELECTRONICS/ DRIVER'S AREA**

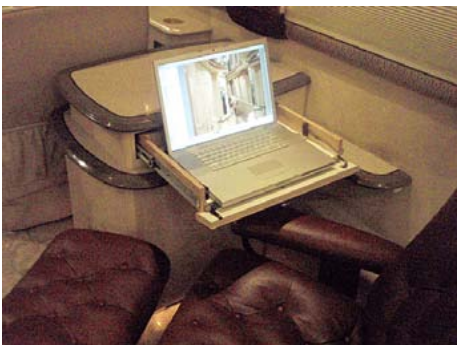

Desk with computer drawer



Electrical control panel

- Air operated stepwell cover with dual controls at driver and passenger side
- Doorbell button at front door
- Lighted handrail at inside entry
- Mirrored stairwell walls
- Solid surfacing entry stairs
- Upholstered and padded entry step pads - secured with Velcro for easy removal for cleaning or replacement
- Blacked-out front overhead cabinet with TV behind acrylic panel
- Upholstered & padded bullnose edge on bottom of forward overhead cabinet

## Galley



Galley seen from salon, decorative glassware cabinet upper right



Cooking center to the left, refrigerator to the right



Cooktop



Convection/microwave oven



Concealed coffee maker, trash compactor, covered sinks



Sink area showing serving bar with concealed glass storage



Dual sinks



Concealed glass storage

- Upholstered passenger dash
- Electric privacy shades for driver & passenger with controls at driver's dash and passenger cabinet
- Electric sun visors for driver & passenger with controls at driver's dash and passenger cabinet
- Exclusive Liberty Coach custom upholstered driver's dash with illuminated dash panels, operator indicator and warning lights
- Custom Burlwood dash panels
- Isringhausen air-ride custom upholstered leather drivers seat with electric base
- 28" leather Villa six-way power co-pilot seat with footrest & swivel base
- Driver and passenger map lights
- Digital clock positioned for ease of drivers viewing and readable for passenger and from living room and galley area
- Ergonomically engineered gauge and switch locations at driver's dash
- Generator battery gauge
- Generator temperature gauge
- DC Amp and Voltmeters for engine and house batteries at dash
- Master lighting switch control at passenger cabinet
- Tivoli accent lighting master switch control at passenger cabinet
- Electric bay door locks with controls for driver and passenger
- Upholstered entrance door with decorative design
- High resolution color back-up camera interfaced to the Alpine dash display
- Key ring hanger at entrance door designed to hold 5 sets of keys
- 2 tier driver console with drawer storage, cup holder, and recessed snack tray
- Generator stop/start controls at dash, galley, bedroom, & lower compartment

### CABINETRY/GALLEY/LIVING ROOM

- High quality laminate finish on all cabinets
- Solid surfacing countertops with integral drip edge design
- Solid surfacing dinette table with 2 chairs with upholstered seats
- Corian double-bowl galley sink with sink covers
- Sink cover storage rack
- Decorative accent lighted glassware cabinet

**Hall and dressing area**



Hallway to bedroom in dressing area



Closets and dressing area, shower

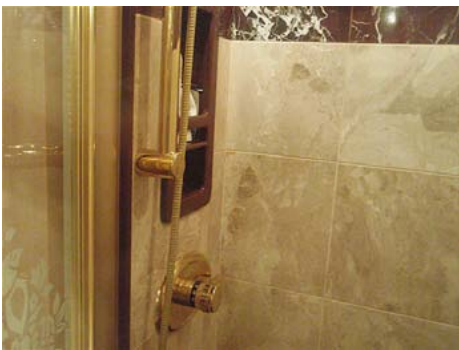

Temperature-controlled marble shower

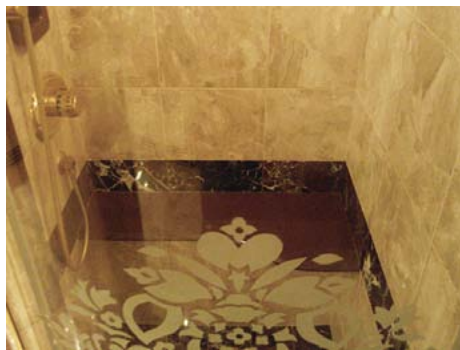

Shower seat



Separate toilet room with generous storage cabinets



View of vanity, shower and dressing area with salon door closed



Sink in toilet room



Concealed stacking washer and dryer

- Additional concealed beverage glass storage in galley
- Custom tile backsplash at cooktop and sink areas
- Roll-out pantry with adjustable wire shelving
- Concealed paper towel holder
- Concealed coffeemaker
- Microwave/convection oven
- Lighted and etched glass splash shield
- 20 cubic foot Amana built-in style refrigerator with ice & water dispenser in door
- 2-burner Gaggenau cook top with cover
- All interior walls of cabinets fully finished and laminated
- All cabinetry manufactured of hardwood and marine grade plywood
- Cabinets are attached directly to coach framework
- All cabinet doors and drawers have positive catches
- Single lever galley faucet with integral spray nozzle
- Liberty Coach designed mirrored and upholstered ceiling throughout with abundant halogen down lighting on dimmers
- CAD/CAM manufactured window frame surrounds designed to fit to coach window profile to allow most spacious "open" interior feeling
- Custom sofa with drawer storage below
- Liberty designed office desk with generous electrical connections and cable passthroughs
- Custom decorative throw pillows
- Upholstered walls
- Upholstered window sills
- Tivoli accent lighting in windows
- Individual remote electric window shade for each window
- Abundant halogen down lighting with dimmers above sofas
- Marble flooring throughout except bedroom
- Toe board accent lighting throughout coach

**BATHROOM**

- Private bathroom with toilet and large vanity area
- Headhunter Royal Flush water jet anti-fume porcelain toilet

## Stateroom



Stateroom vanity



Hanging closet, entertainment center, storage behind headboard, ceiling fan



Hanging closets behind headboard, return air grill, SMX CruiseAir control



Desk and display area, full depth cabinet drawers, tip-out drawers



Make-up cabinet with lighted mirror



Air operated lift-up bed with safe

- Fantastic Vent bath fan with rain sensor in toilet room
- Fantastic Vent bath fan with rain sensor in shower
- Halogen lights above each vanity with adjustable directional lighting
- Mirrored bath/hall ceiling
- Kenmore stacking washer and dryer
- Mirrored closet doors in bath/hall
- Marble shower with seat and shampoo caddy
- Half-round glass shower door with etching
- Brass Grohe automatic temperature/pressure controlled shower valve with hand sprayer

## STATEROOM

- High quality laminate finish on cabinetry
- Mirrored accent bedroom ceiling
- Upholstered lower walls
- Reading lights above bed
- Abundant halogen down lighting on dimmers
- Enclosed vanity area at foot of bed with lighted, magnifying make-up mirror
- Generous mirrored closets behind bed
- Individual remote electric window shade for each window
- Queen size bed
- Upholstered bed base
- Bed raised on toe board with decorative accent lighting underneath
- Custom bedspread
- Air bed deck lift
- Storage area under bed deck
- Ultrasuede and fabric upgrades
- Custom made decorative throw pillows
- Large safe under bed
- Digital clock with alarm, snooze button and dimmer